

SOME DESIGN GUIDANCE FROM THE PLANNERS

*Examples of what **not** to do to an old building*



Inappropriate alterations which will contribute to the destruction of an old property's character:

- 1 Oversized dormer – dominates scale of the roof.
- 2 Modern rooflights on the prominent side of the roof.
- 3 Satellite dish aerial – in full prominence.
- 4 uPVC modern windows top hung with casement replacing original sash windows with glazing bars.
- 5 Stuck-on 'veneer' of stonework covering original attractive brickwork.
- 6 Enlarged window opening destroying vertical emphasis of the original sash window.
- 7 Modern, flat-roof porch with fake Georgian door and alien, built-in fanlight.
- 8 Mixture of brick and ornamental concrete block wall with timber gate replacing popple wall.
- 9 Incongruous flat roofed garage extension, with metal up and over door.

Garage and Porch extensions which may be appropriate, depending on the character of the existing property.

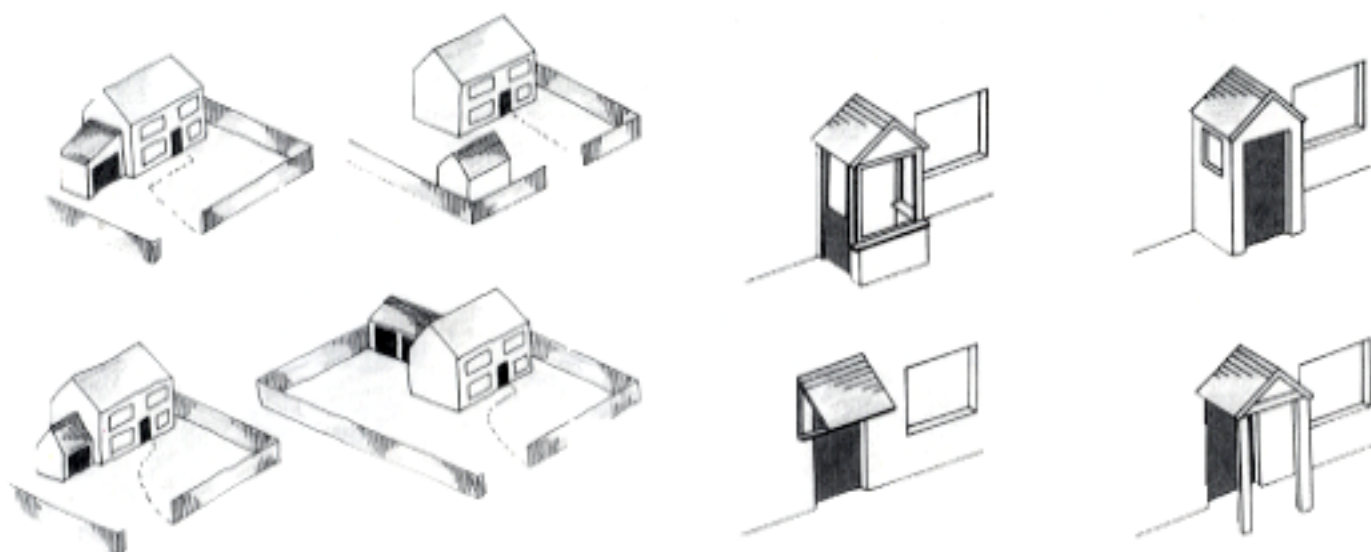

Text and Sketches by Planning Department, EDDC